

Per tutti i nostri ventilatori
che dispongono dell'attacco a slitta:

*For all our fans with
the slide mounting:*

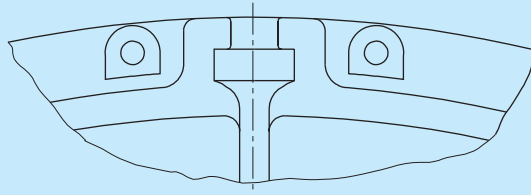

Sono disponibili i seguenti kit di fissaggio:
The following mounting kits are available:

KIT Cod. 3013.0014

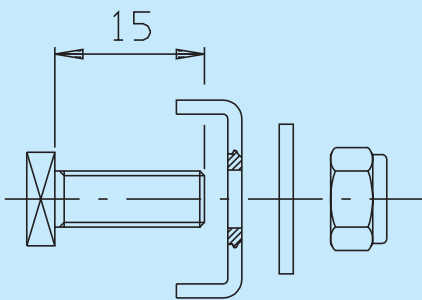

KIT Cod. 3013.0015

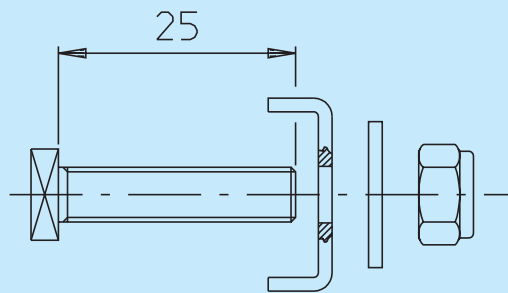

Kit composto da bullone M6 testa quadrata, dado, rondella e rinforzo ad "U".
Kit comprised of M6 bolt with square head, nut, washer and "U" stiffener.

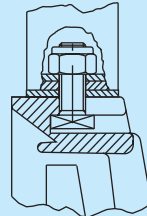
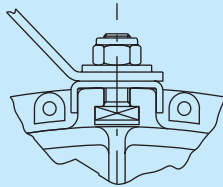

Cod. 3013.0010

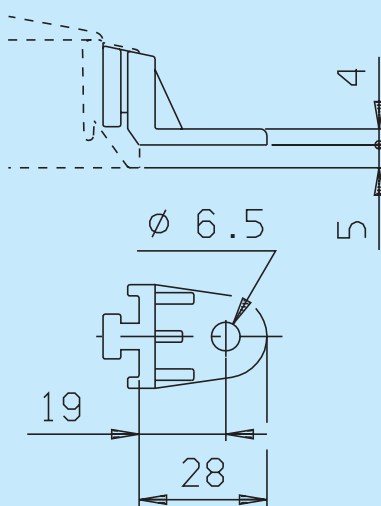

Cod. 3013.0017

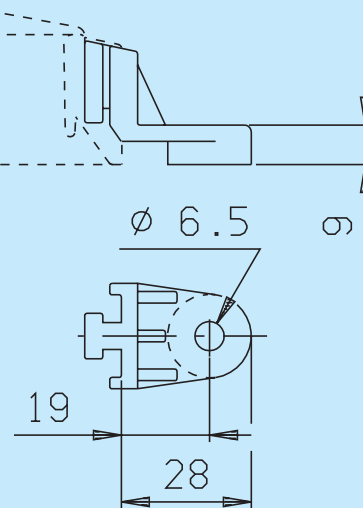

Cod. 3013.0033

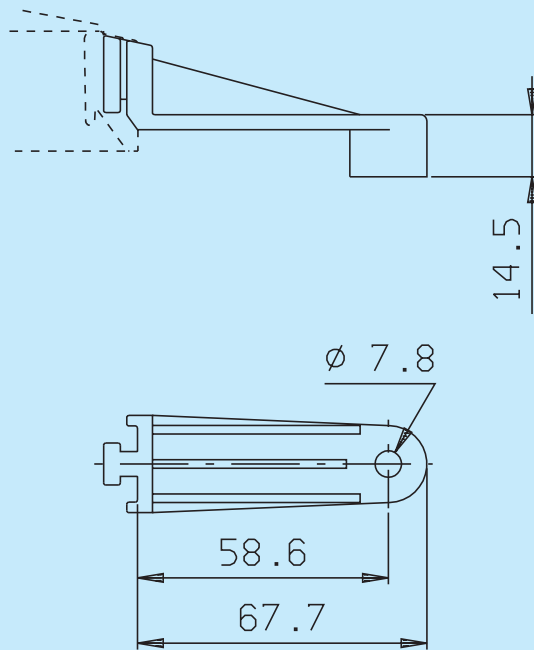

Cod. 3013.0032

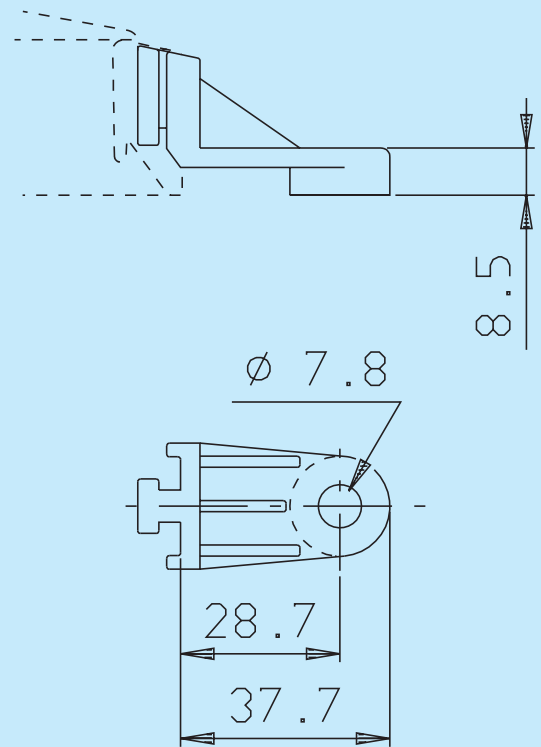

Cod. 3013.0059

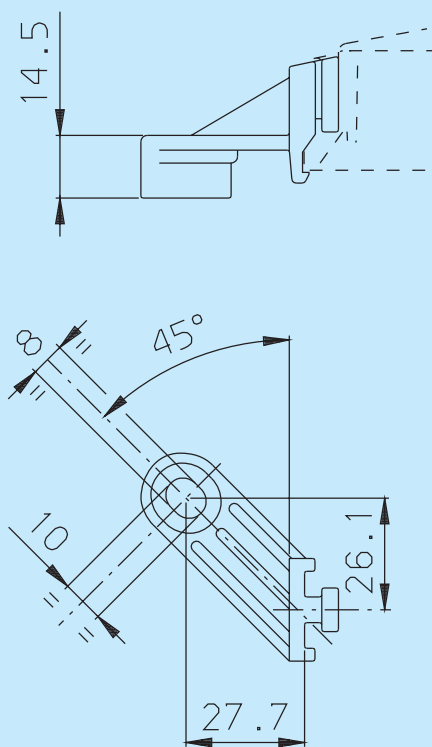

Cod. 3013.0060

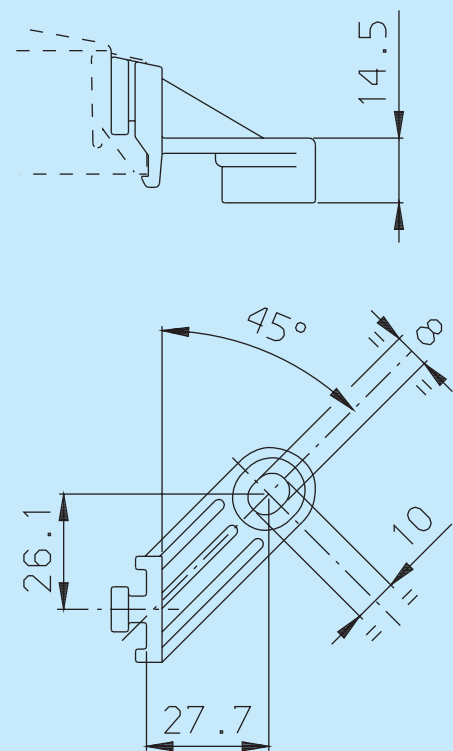

KIT Cod. 3013.0011 KIT composto da orecchietta, staffa e bullone di fissaggio
KIT consisting of a bracket, a rod and a fixing bolt.

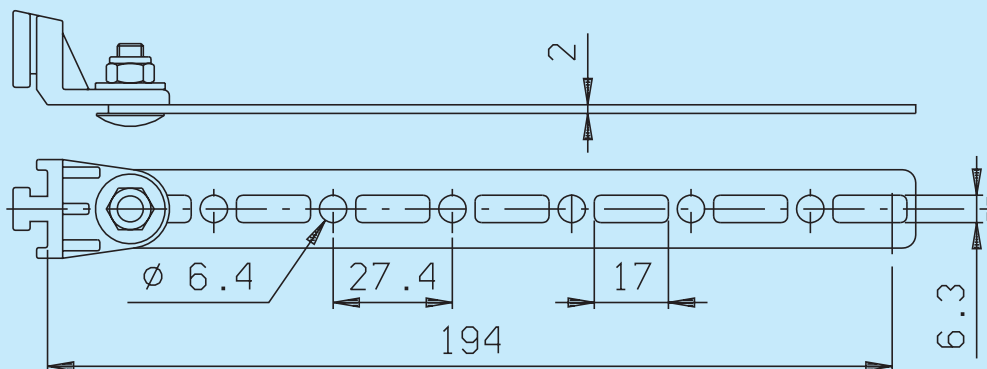

Le orecchiette possono essere sistemate a piacere e le staffe possono essere ruotate nella posizione più conveniente per il fissaggio. Con questo Kit, il ventilatore può essere montato su qualsiasi tipo di radiatore.

The brackets can be fixed as you like and the rods can rotate to the most convenient position for the assembly. With this kit, the fan can be fixed to every type of radiator.

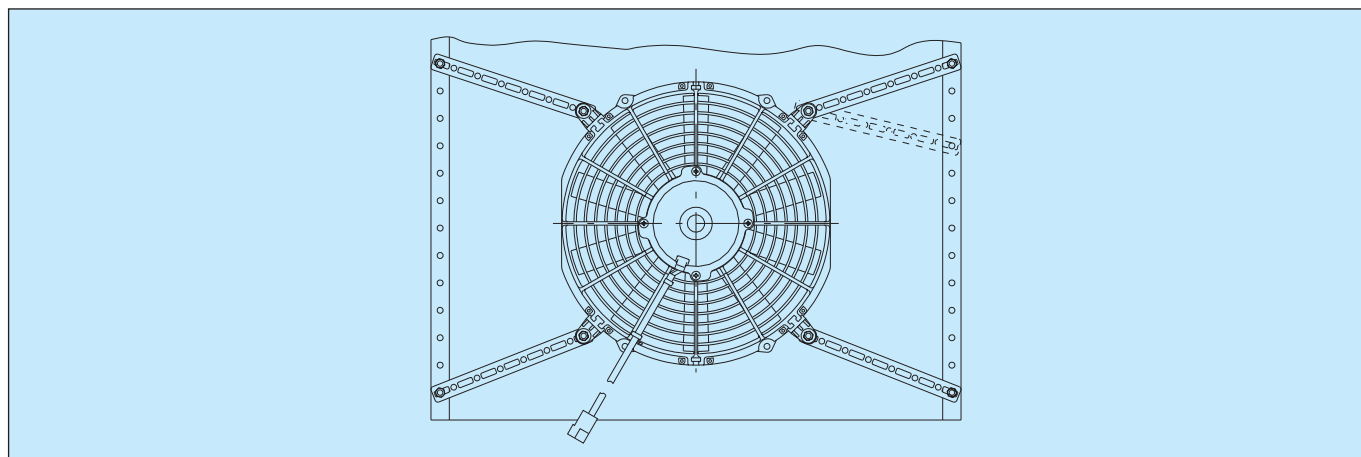

Qui di seguito sono riportati i massimi diametri raggiungibili con questo tipo di kit in funzione del diametro della ventola del ventilatore:

Below, you can see the maximum diameter that can be connected with this kit, according to the diameter of the fan:

Diametro della ventola (mm) <i>Fan diameter (mm)</i>	Massimo diametro raggiungibile (mm) <i>Max. diameter that can be joined (mm)</i>
385	806
350	770
330	746
305	723
280	697
255	672
225	642



KIT Cod. 3013.0013 KIT composto da un perno Ø 2 x 180, rondella di gomma e molletta.
KIT consisting of a Ø 2 x 180 pin, rubber washer and stop-spring.

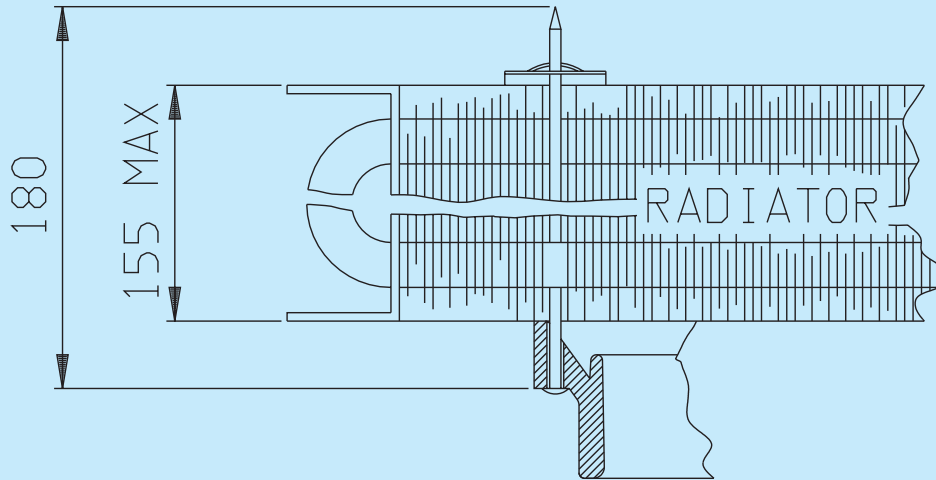

Cod. 3013.0062 Staffa di unione per ventola tipo **VA26** (Vedi pag.54,55,175,176)
Connecting bracket for VA26 type fan (See pag.54,55,175,176)

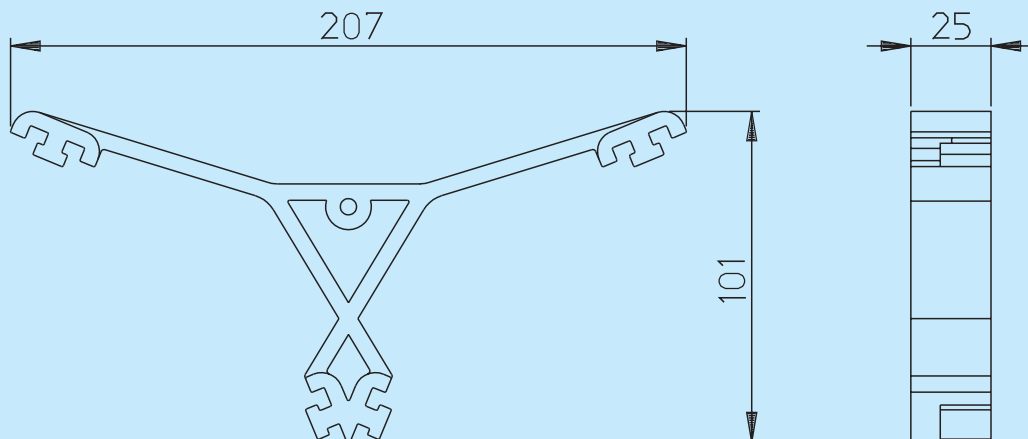

Esempi di applicazione
Example of applications

